

Smart Toilet

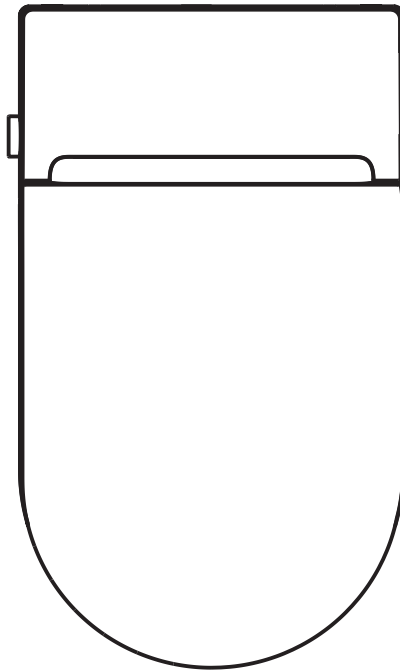

Model: ST-ZTT-280

The concord smart toilet ST-ZTT-280 complies with WMTS-051 and features an integrated Atmospheric Vacuum Breaker (AVB) that satisfies the high-hazard backflow prevention criteria of AS/NZ 3500.1 without the use of an RPZ valve.

Installation shall be in accordance with the AS/NZS3500 series of Standards
Working Water Pressure: 200Kpa-0500Kpa

- Be sure to read this User Manual before using your product and keep it for future reference
- Please follow your dealer's instruction and fill in the purchasing date and shop name, etc.

TABLE OF
CONTENTS

SAFETY PRECAUTIONS1

PARTS NAMES3

USER MANUAL4

PRODUCT INSTALLATION 7

DAILY MAINTENANCE9

AFTER- SALE INSTRUCTIONS11

TROUBLE SHOOTING13

SPECIFICATIONS14

ACCEPTANCE CHECK15

SAFETY PRECAUTIONS

These precautions are important for safe usage. Be sure to follow them and use the product correctly. (This manual is for reference only. If the product updates or the contents of the manual are not thorough, the final interpretation right belongs to Manufacturer)

SYMBOLS AND MEANINGS



WARNING

May result in death or serious injury.



CAUTION

May result in injury or property damage.

The following symbols are used to indicate important safety instructions for the use of the product.

SYMBOL	MEANING	SYMBOL	MEANING
	This symbol indicates a prohibited use of the product.		This symbol is used to indicate a required step in the use of this product.



WARNING



- ◆ Do not plug or unplug the power plug with wet hands, doing so may cause electrical shock.
- ◆ Do not get any water or cleaning solution on the main unit or power plug, doing so may cause fire, electrical shock, heat or short circuit, doing so may cause the product to crack resulting in injury or water damage.
- ◆ Never disassemble, repair or alter, doing so may cause fire, electrical shock, heat or short circuit.
- ◆ Do not use the unit if a malfunction occurs, in case of malfunction, please cut off power by means such as unplugging the power plug or switching the breaker in the distribution board to OFF. Close the water shut off valve to stop water supply. Continued use after malfunction could cause a fire, electrical shock, heat, short circuit, injury or water damage.
- ◆ Do not use other water allowed by the laws and ordinances of the region of use.
- ◆ Only use drinking water. Do not use seawater or recycled water, doing so may cause irritation to the skin and malfunction.
- ◆ Do not touch the power plug during thunderstorms, doing so may cause electrical shock.
- ◆ Do not allow the water supply hose to touch the power plug or outlet, doing so may cause condensation resulting in a fire, electrical shock, heat or a short circuit.
- ◆ Do not do anything that may damage the power cord or power plug, do not strike, yank, twist, excessively bend, damage, alter, or heat the power cords. Also, do not place anything heavy on, bind or pinch the power cords. Using a damaged power cord may result in fire, electrical shock, heat, or short circuit.
- ◆ Do not use any power supply other than the one specified (AC 220V-240V, 50Hz).
- ◆ Do not use a loose or faulty electrical outlet, doing so may cause fire, excessive heat or a short circuit.
- ◆ Do not stick a finger or anything else into the warm air outlet, doing so may cause burns, excessive heat or a short circuit.
- ◆ Keep cigarettes and other open flames away from the product, failure to do so may cause fire.
- ◆ Do not install the product on moving vehicles such as wheeled vehicles or boats, doing so may cause fire, electrical shock, short circuit or malfunction, the toilet seat, toilet lid, or other parts may come loose and fall off, resulting in injury.
- ◆ Use the new hose set included with this equipment. Do not reuse an old hose set.



WARNING

- ◆ **Be aware of low temperature burns**, refrain from sitting on the seat for long periods. It may cause low-temperature burns. To prevent the following persons from getting a moderate temperature burn during use, other person should turn off the toilet seat heater and set the dryer temperature to "Low". Young children, the aged and other users unable to set the temperature appropriately themselves. The ill, physically disabled and others who do not have freedom of movement. Those using any medicines that cause drowsiness (sleeping or cold medicine), those who have been drinking heavily, anyone severely fatigued and anyone else liable to fall asleep.
- ◆ **Be sure to use a socket with a load of 2KW or more, Socket as far as possible**, not doing so may cause fire or short circuit.
- ◆ **Make sure that a properly grounded (3 prong) outlet has been installed**, failure to install a grounded outlet could cause electrical shock in the event of a malfunction or short circuit.
- ◆ **To unplug, hold the power plug, not the power cord**, pulling on the power cord may cause damage and result in fire or heat.
- ◆ **This is an electrical product. Do not install it anywhere water is likely to get on the product** or anywhere with humidity high enough that water is likely to form on the surface of this product.
- ◆ **When using the product in a bathroom, install a fan or ventilation port and ensure good air flow through the bathroom.** not doing so may cause fire and electrical shock.
- ◆ **Always unplug the power plug from the outlet before maintenance or inspection**, failure to do so may cause electrical shock or malfunction (nozzle cleaning excluded).
- ◆ **If the electric cord is damaged, avoid danger by having the manufacturer's repair department or equivalent specialist replace it.**
- ◆ **Following safety steps should be followed when using this unit, especially children.**
 1. Do not place the unit where it is likely to fall into bathtub or basin.
 2. Never place the unit in water or other liquid.
 3. In case the unit falls into water, please unplug the power and never touch the unit by hand.
 4. Do not use the unit when taking a bath.
- ◆ **Warning: To reduce burn, electrical shock, fire or injury, please follow**
 1. Children or people with sickness must be supervised when using the unit.
 2. Children should be supervised to ensure that they do not play with the appliance.
 3. This appliance is not intended for use by persons (including children) with reduced physical, sensory or mental capabilities, or lack of experience and knowledge, unless they have been given supervision or instruction concerning use of the appliance by a person responsible for their safety.
 4. Only use the application as stated in this User's Guide.



CAUTION

- ◆ **Do not apply strong force, mechanical shock, step on or stand on the toilet seat, toilet lid or top unit.**
- ◆ **Also do not place any heavy object on the toilet seat, toilet lid, or top unit.**
Doing so could cause cracking or cause the toilet seat or lid to come loose and fall, resulting in injury. Doing so could damage the product and cause injury or water damage.
- ◆ **Do not fold or crush the water supply hose; do not damage by cutting with a sharp object**, doing so may cause water leaks.
- ◆ **Do not pour hot water into the toilet**, doing so may result in damage to the toilet, injury or water damage.
- ◆ **Do not wipe this product with toilet cleaner, household cleaner, benzene, paint thinner, powdered cleanser or nylon scrubbing brush.**
These items may damage or crack the plastic and cause injury or malfunction.
These items could damage the water supply hose and cause a water leak.
- ◆ **Keep the unit away from heated surfaces**, doing so may cause deformation, discoloration or malfunction.
- ◆ **Never flush newspapers, pads or sanitary pad, etc. which may clogged toilet.**

- ◆ **If a water leak should occur, always close the shutoff valve.**
- ◆ **When the ambient temperature is likely to drop to 32°F(0°C) or lower, prevent damage to the pipes and hoses due to freezing.**
Frozen water pipes could cause the top unit and the pipes to break, resulting in a water leak. Regulate the room temperature to prevent the pipes and hoses from freezing during cold months.
- ◆ **Wipe any urine, condensation, cleaner, water, etc. That has gotten on the floor with a well wrung mop or cloth**, failure to do so may cause staining and corrosion of the floor.
- ◆ **When not using the product for a long time, close the shutoff valve, drain the water from the top unit and water supply hose, and unplug the power plug from the outlet.**
When using the product again, allow the product to refill with water first. Otherwise, the water in the tank might become contaminated and cause skin inflammation or other problems. Leaving the power on may cause fire or heat.

PARTS NAMES

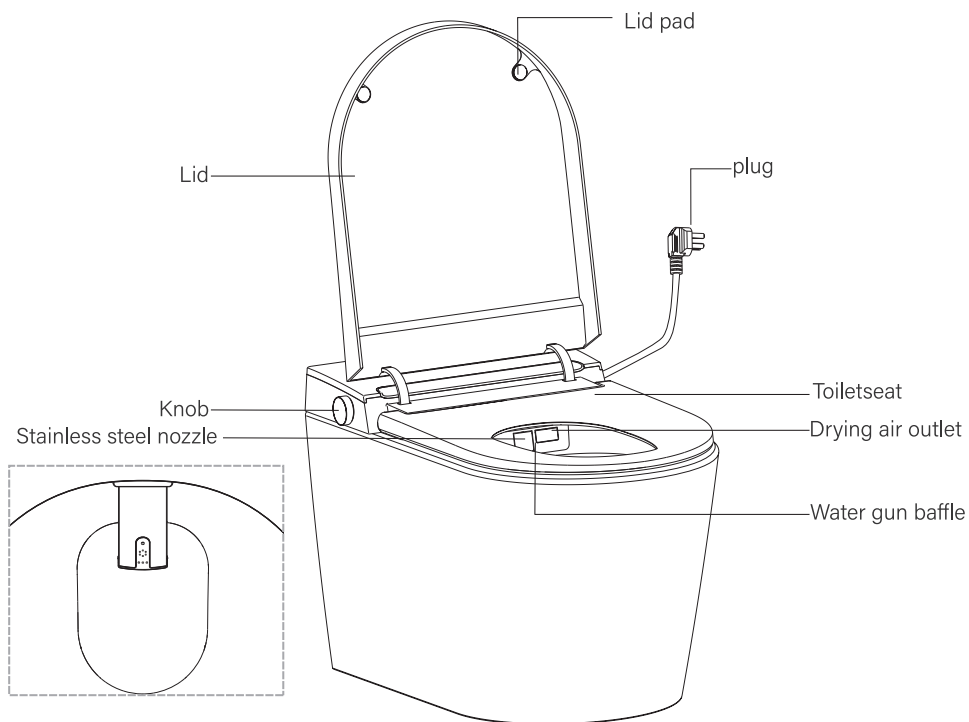

Product Size: (mm)

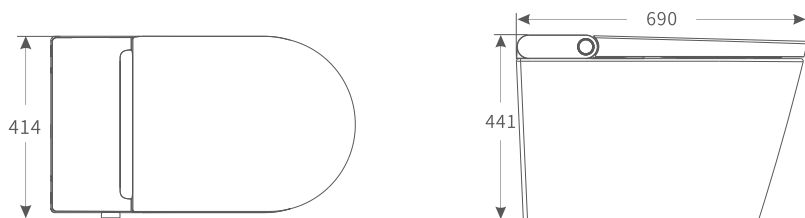

Accessories



Remote control
(including bracket and
expansion bolt)



User manual

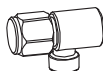

Triangle valve



AAA batteries



Battery box

USER MANUAL

Knob Function



Rear wash: Turn backward  after seatting, nozzle will come out automatically and wash bottom back and forth repeatedly. Turn backward again to fix nozzle position.

Default cleaning for 1 minute without press. Then auto flush and drying.





Front wash: Turn forward  after seatting, nozzle will come out automatically and wash back and forth repeatedly. Turn forward again to fix nozzle position.

Default cleaning for 1 minute without press. Then auto flush and drying.



Flush: Press  to flush toilet. Waiting for the indicator light to complete function. Press the flush button again after the light goes out if you need.



Stop: Press  to stop rear wash, front wash, dryer and nozzle cleaning functions. Rear wash, front wash and nozzle cleaning will last for 3 minute and dryer will last for 4 minutes without press .

Remark: Long press   to start dryer for 4 minutes. Press again to stop dryer.



REMOTE CONTROL

The marks on the remote control may vary depending on the model. Please read the function description.

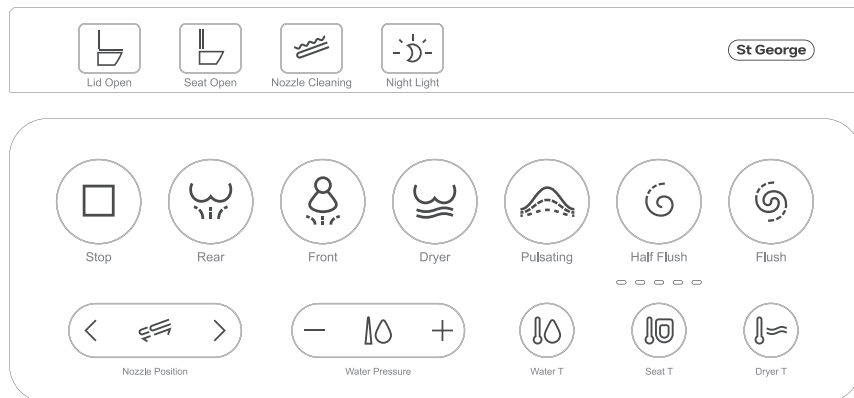

How to match remote control:

1. Close the power of toilet;
2. Reopen the power, long press button "□" + "Seat T" within 15 seconds;
3. Match function will start in 3 seconds, indicator light on the remote control shining;
4. If match succeed, press any button on the remote control, you will hear buzzing sound;
5. If failed, repeat above process 1-4.

Attention: Do not cut off power during matching, otherwise may caused failure of match and unable to use remote control.

Remote control function description



Stop

Press □ to stop rear wash, front wash, dryer and nozzle self-cleaning function. Long press □ 3 seconds to standby mode. Press any key on remote control or side button or sit to exit standby mode.

→ Rear wash, front wash and nozzle self-cleaning will last for 3minute, dryer will last for 4 minutes without press □ .



Rear

When seated, press rear nozzle will come out and wash bottom back and forth repeatedly. Press again to fix nozzle position.

→ During rear wash, press □ top stop. Default cleaning for 180 seconds without press □.



Front

When seated, press nozzle will come out and wash back and forth repeatedly. Press again to fix nozzle position.

→ During front wash, press □ top stop. Default cleaning for 180 seconds without press □.



Dryer

Dry for the washing area. When seated, press to start air dryer last for 4 minutes, press □ to stop.

→ Remark: When seated, first press of dryer button, machine will flush firstly then drying. Second press this button will start dryer directly.



Pulsating

In the cleaning state, press to turn the massage function on or off.



Water Pressure



When using rear wash, front wash or defecation function, press $- +$ to adjust the water pressure for 5 levels, meanwhile the setting will be saved. Short press $+$ to increase pressure by 1 level, short press $-$ to decrease pressure by 1 level.

Mute mode: long press $-$ to change to mute mode, long press again to quit.



Nozzle Position

When using rear wash, front wash or defecation function, press $< >$ to adjust the nozzle position for 5 levels, meanwhile the setting will be saved. Short press $<$ to increase position by 1 level, short press $>$ to decrease position by 1 level.



Lid Open

Press "Lid Open" to open lid, press again to close lid, Press together "Lid Open" + \square to operate auto open/close lid.



Seat Open

Press "Seat Open" to open seat, Press again to auto close.

When induction radar is on, seat auto close after leaving seat 2 minutes.

※ When seat and lid all closed, press "Seat Open" to open lid and seat in turn.

※ When seat and lid all open, press "Lid Open" to close seat and lid in turn.



Water T



Press "Water T" to open function, press again to adjust water temperature, final temperature will be saved.

water temp level	null	level 1	level 2	level 3	level 4	level 5
indicator light	○○○○○	●○○○○	●●○○○	●●●○○	●●●●○	●●●●●



Seat T



Press "Seat T" to open function, press again to adjust seat temperature, final temperature will be saved.

seat temp level	null	level 1	level 2	level 3	level 4	level 5
indicator light	○○○○○	●○○○○	●●○○○	●●●○○	●●●●○	●●●●●



Dryer T



Press "Dryer T" to open function, press again to adjust dryer temperature, final temperature will be saved automatically.

dryer temp level	null	level 1	level 2	level 3	level 4	level 5
indicator light	○○○○○	●○○○○	●●○○○	●●●○○	●●●●○	●●●●●



Nozzle Cleaning

Press this button to clean the nozzle, and stop working after about 3 minutes. Short press the button twice to extend the gun barrel for manual cleaning.



Night Light

Press "Night Light" to light up the LED night, convenient for using toilet at night. Press again, light turn off.



Half Flush

Press "Half Flush" to activate the half flush.



Flush

Press "Flush" to flush the toilet.

Auto flush: 1. Auto flush when running dryer function.

2. After seating for over 6 seconds, auto flush after leaving seat.

3. Long press the flush button to turn off the off seat flush function.

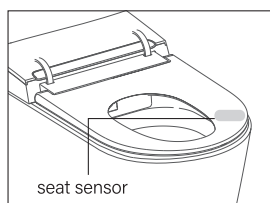
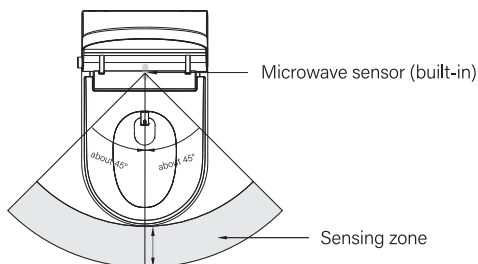
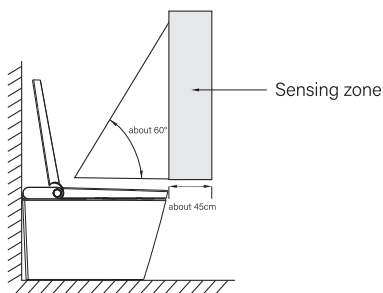

※ All functions of toilet can be used only after seated.

PRODUCT INSTALLATION

Water inlet and drainage position reference

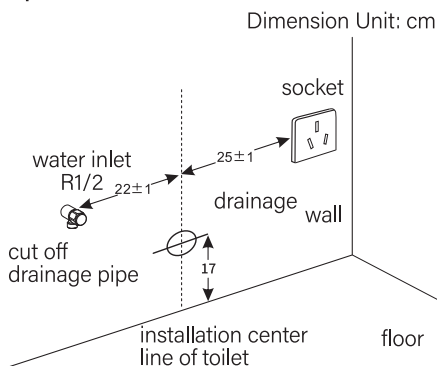

Remark: It is recommended to install water and electricity according to the dimensions shown in the diagram, otherwise it may cause the risk of pipe bending.

1 HOW TO INSTALL REMOTE CONTROL

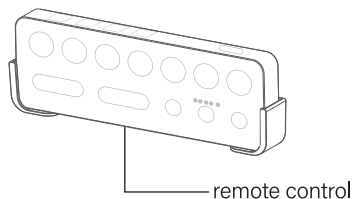

- ① Drill 2 holes on the wall (easy for you to reach when seated)
- ② Fix the remote control holder to the wall with expansion screws.
- ③ Fix the remote control on the holder.

※ Remark: size of expansion screw and drill shall be measured with application.

How to fix T-valve, power cord and adjust water flow.

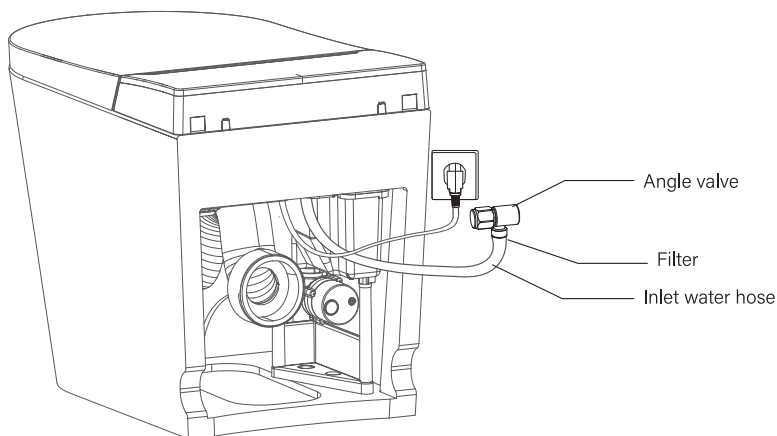

- ① Take off the filter blocker (ensure the filter remains in place).
- ② Connect hose to Angle valve and tighten it.
- ③ Turn to open the angle valve.

Water supply pressure: 150kPa – 500 kPa
Water supply flow: $\geq 12\text{L/min}$

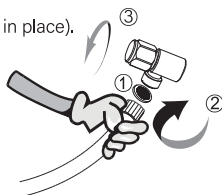

* If water pressure is too high, turn clockwise.

If water pressure is too low, turn counterclockwise.

3 POWER SUPPLY AND OPERATION

- ① Plug the plug into the 240V/50Hz socket and ensure well grounded.
- ② Test all functions to check if all run properly.
- ③ Clean up after installation.

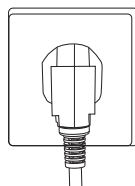

DAILY MAINTENANCE

1 HOW TO CLEAN THE NOZZLE

- ① Press and hold the "Nozzle Position ∨" button on the remote control to clean the nozzle.

※ Remark: Nozzle will wash itself before and after each use during rear wash and front wash.

- ② Press and hold the "Nozzle Position ∧" button to extend the nozzle for manual cleaning.

-- Brush the nozzle.

-- Press ☐ to retract the nozzle.

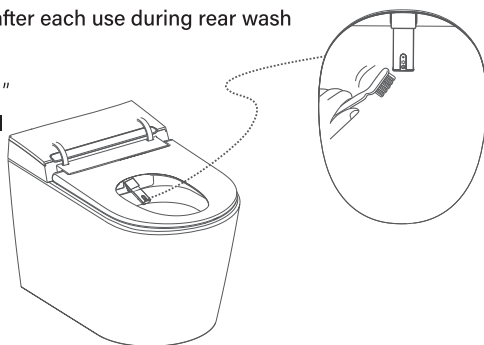

2 HOW TO CLEAN THE SMART TOILET

※ Please cut off the power before cleaning the unit.

- ① Wipe the outside of toilet with a wet cloth.
- ② Using wet cloth to wipe off any cleaner that remains on the unit.
- ③ For heavy dirty, wipe with a soft cloth soaked in diluted, neutral kitchen detergent, and then wipe with a soft cloth soaked in water.

※ Remark: 1. When cleaning, do not leak the residual water into the toilet.
2. The seating sensing position shall be kept clean to prevent incorrect function operation.

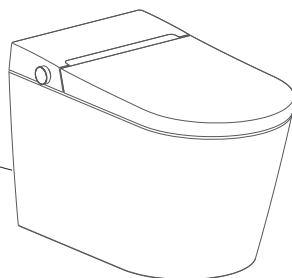

HOW TO DO WHEN POWER AND WATER SUPPLY FAILURE

IN CASE OF POWER SUPPLY FAILURE

Emergency battery is built-in, in case of power failure, press  on the side control knob to flush.

IN CASE OF WATER SUPPLY FAILURE

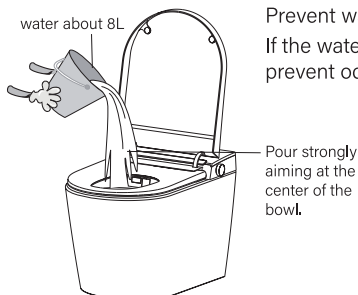

Pour water strongly from a large bucket, aiming the center of the bowl. Bucket is about 8L.

Prevent water overflowing from the bowl.

If the water level is low after flushing, add more water slowly to prevent odors.

LONG PERIODS OF DISUSE

HOW TO DRAIN THE WATER

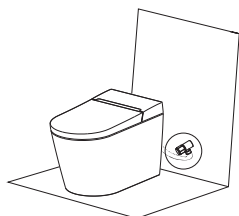

1 Turn to close the angle valve.



2 Loosen and disconnect the water supply hose to drain water.

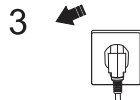

3 Cut off power or unplug the plug.

※ Poor water quality may cause dermatitis and product damage.

HOW TO RESUPPLY THE POWER

1. Connect water supply hose firmly to Angle valve.
2. Open Angle valve, make sure no leakage.
3. Turn on power.
4. Wait for 10 seconds, press " Flush " to clean the bowl.
5. Press "NOZZLE CLEANING" on remote control, nozzle will self-clean. (Suggest to repeat more times)
6. Cover seat sensor with wet cloth and press "REAR WASH" to wash nozzle for 60 seconds, meanwhile collect the water with paper cup.

※ Remark: Steps 4, 5, 6 are to drain water inside the unit and wash water hose.

AFTER- SALE INSTRUCTIONS

Separation steps for internal maintenance

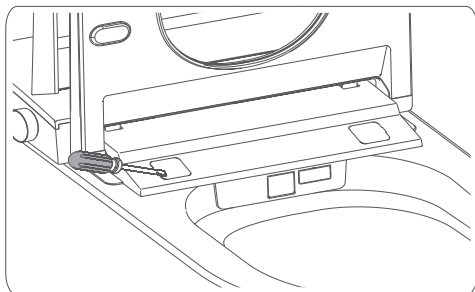
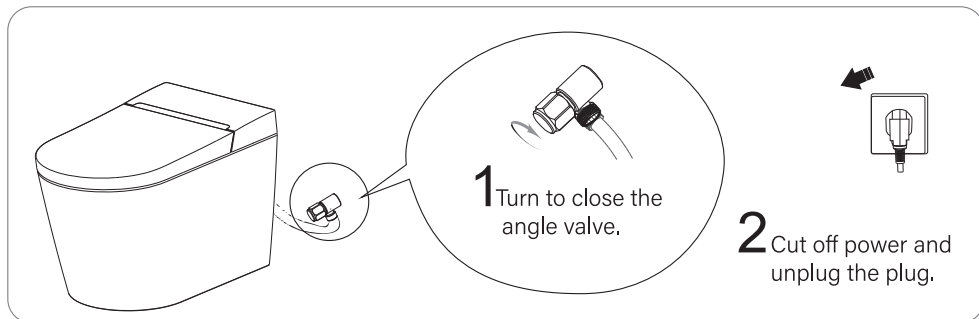

- 3** First pry off the screw cover with a slotted screwdriver, better to put a cloth under the screwdriver to avoid scratching the seat. Then loosen the two long screws with a cross screwdriver.

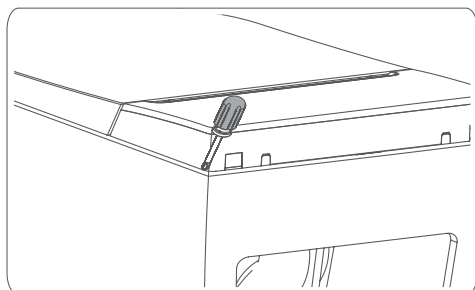

- 4** Then loosen the side screw with a phillips head screwdriver to repair the upper components.

Separation steps for water tank/water pump maintenance

1-3 steps same as "Separation steps for internal maintenance", please follow that steps for operation.

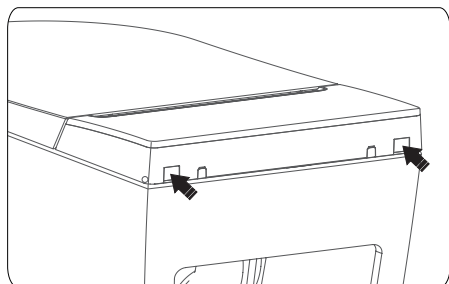

- 5** Press the release key with force and meanwhile pull the upper parts upwards.

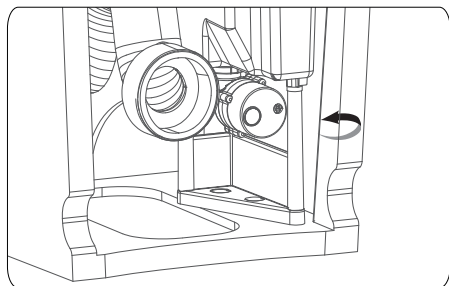

- 7** Screw clockwise the drain hole under water tank to drain out the water in case long periods of disuse or toilets needs to transport.

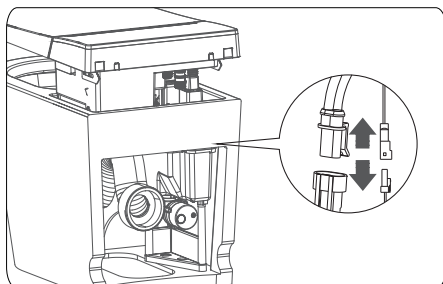

- 6** Release the connection for the bottom of upper parts and water tank, so that 2 parts could be separate completely.

TROUBLE SHOOTING

■ Confirm the actions described below before your repairment.

TROUBLES	CHECK REASONS	SOLUTIONS
Functions does not work	Is it power failure?	Waiting for power supply.
	Is the circuit breaker turned off?	Turn on the circuit breaker.
	Is the socket loose or poorly connected?	Plug the power plug firmly and ensure power supply.
	Is the power off?	Turn on the power switch.
The nozzle does not spray water	Has a water failure occurred?	Waiting for water supply.
	Is the Angle valve closed?	Open the shutoff valve.
	Is the water supply hose bent?	Stretch the water supply hose.
Cleaning water pressure is weak	Is the water pressure set to a low level?	Reset the water pressure. ➡Ref.Page 6
	Is the nozzle clogged with foreign matter?	Clean the nozzle. ➡Ref.Page 10
Cleaning water temperature is low	Is the water temperature set to "OFF" or a low level?	Reset the water temperature. ➡Ref.Page 6
Water stops when using	Did you continuous use washing function for 60 seconds?	Press rear wash or front wash, again.
	Did you move after sit down?	Press rear wash or front wash, again.
Toilet seat is cold	Is the seat termperture set to "OFF" or a low level?	Reset the seat temperature. ➡Ref.Page 6
Dryer temperature is low	Is the dryer temperature set to low level?	Reset the dryer temperature. ➡Ref.Page 6
Dryer does not work	Is the occupied sensor is seated correctly?	Make sure to seat correctly.
Dryer stops when using	Did the dryer continuous working for 3 minutes?	Press dryer button again.
Remote control failure	Low battery for remote control?	Replace the battery.
Not flushing automatically	Is the water supply failure?	Waiting for water supply.
	If the Angle valve shutoff?	Open the shutoff valve.
Waste does not flush down completely	Other running water fixtures share the water supply.	— —
Power supply failure during flush,and toilet continuous flushing	Is the power sudden failure during flushing?	Manually close the water inlet valve,and reopen after power is supplied.

SPECIFICATIONS

Description			Smart toilet
Rated voltage			AC 240V,50Hz
Rated power			1200W Inlet water temperature 15℃, inlet water pressure 0.2MPa, maximum temperature of effluent is set at highest level of front wash.
Power cord			Effective length ≥1.0m(grounded)
Cleaning	Type of water heater		Instant heating
	Water Temp		6 levels (Room temp~about 39℃)
	Cleaning flow	Rear wash	About 550ml/min±150ml
		Front wash	About 700ml/min±150ml
		Defecation/Wide wash	About 700ml/min±150ml
	Cleaning type	Rear wash	Gentle aerated wash, oscillating and pulsating feature.
		Front wash	
	Water heater power		MAX: 1900W
Safety device		Flow sensor+water temperature sensor+temperature fuse+thermostat	
Dryer	Air temperature		6 levels (Room temp~about 52℃)
	Airflow velocity		≥4 m/s
	Dryer heater power		MAX: 300W
	Safety device		Bimetal fuse switch+temperature fuse
Deodorization	Deodorant		High efficiency activated carbon catalyst deodorization
	Airflow volume		≥0.2 m³/min
Seat device	Seat temperature		6 levels (Room temp~about 39℃)
	Seat heater power		About 50W
	Safety device		Temperature sensor+temperature fuse+thermostat
	Damping device		Both seat and lid use electric or mon-elcetric damping device
Operating ambient temperature			5~40℃
Water supply temperature			5~35℃
Water supply pressure			Static: 150kPa – 500 kPa
Water supply flow			≥12L/min

ACCEPTANCE CHECK

■ After installation, try to run the toilet and fill in the record sheet.

CHECK LIST			RESULT
Is socket and power supply AC240V, load $\geq 2000W$?			
Is the power socket loose or not? Is it connector properly?			
Is the T-valve open?			
Whether the connection of each accessory is loose or not, whether there is water leakage?			
Is seat and lid open/close normally?			
Whether the nozzle has water leakage?			
Is the "REAR WASH" function running properly(including range test)?			
Is the "FRONT WASH" function running properly(including range test)?			
Is the "DEFECATION" function running properly(including range test)?			
Is the "WATER TEMP" normal(including range test)?			
Is the "DRYER" function running normally(including range test)?			
Is the "SEAT TEMP" function running normally(including range test)?			
Is the "NOZZLE CLEANING" function working properly?			
Is the "DRYER" temperature function working properly?			
Is the "NIGHT LIGHT" function running normally?			
Is side button function working properly?			
Is the remote control working properly?			
Is automatic drainage and manual drainage normally?			
Remark: 			
Seller:		Installer:	Checking Person: Date:

